



**SWITCHMODE/HIGH FREQUENCY
CURRENT SENSE TRANSFORMERS**

80053 Rev. E

DESCRIPTION: Designed for switching power supply applications, TRIAD current sense transformers are used to detect the current passing through a conductor. These transformers are very reliable and operate effectively over the frequency range of 10 kHz to 200 kHz. They are constructed of UL rated 130 degrees celsius materials. Both models are available with a center tap option.

Type No.	ET VuSEC Ref 20 kHz	Turns Count	Min. Ind. mH	DCR Max Ohms	Pri. Amps	Fig.
CST206-1A	2000	100	14.0	.580	110.0 RMS	A
CST206-1T	2000	100 CT	14.0	.580	110.0 RMS	
CST206-2A	4000	200	56.0	3.500	80.0 RMS	
CST206-2T	4000	200 CT	56.0	3.500	80.0 RMS	
CST206-3A	6000	300	130.0	12.400	70.0 RMS	
CST206-3T	6000	300 CT	130.0	12.400	70.0 RMS	
CST306-1A	500	50	3.50	.340	35.0 RMS	B
CST306-1T	500	50 CT	3.50	.340	35.0 RMS	
CST306-2A	1000	100	14.0	1.550	25.0 RMS	
CST306-2T	1000	100 CT	14.0	1.550	25.0 RMS	
CST306-3A	2000	200	55.0	3.750	25.0 RMS	
CST306-3T	2000	200 CT	55.0	3.750	25.0 RMS	

CT = Center Tap

A CST206-KIT is available which includes each one of the components for figure A

A CST306-KIT is available which includes each one of the components for figure B

TECHNICAL NOTES:

1. Derate ET product by 32% for 50 kHz, 52% for 100 kHz and 50 kHz, for unidirectional operation.
2. Rated primary current renders approximately 40 degrees celsius temperature rise.
3. CST206 models have maximum recommended terminating resistance of 1 ohm per turn
4. Primary is inserted through hole in casing
5. 3 pin or center tapped (ct) models are designated with a T suffix. Non-center tapped versions do not have a center pin.
6. Arrow side of Primary conductor has the polarity as Pin 1.

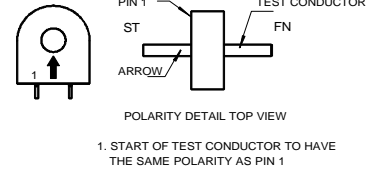
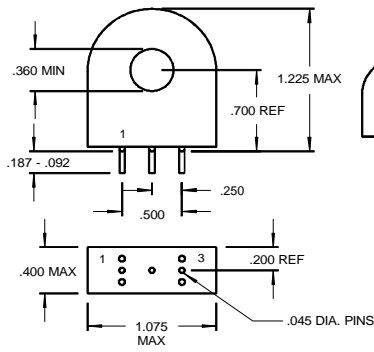

FIGURE A

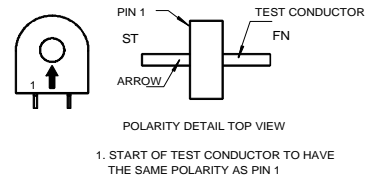
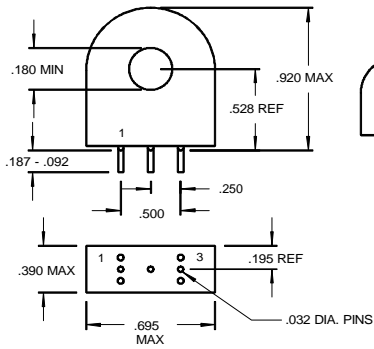

FIGURE B